

OCTOBERFEST

I & II

10.14.23 - 10.15.23



HELD AT



GREAT SOUTHWEST
EQUESTRIAN CENTER

2501 South Mason Rd. #100, Katy, TX

HEALTH REQUIREMENTS:

HORSES ENTERING THE GROUNDS MUST BE ACCOMPANIED BY THE FOLLOWING
DOCUMENTATION:

CURRENT VACCINES: EQUINE INFLUENZA VIRUS AND EQUINE HERPES VIRUS
(RHINOPNEUMONITIS)

VACCINATIONS WITHIN SIX MONTHS PRIOR TO ENTERING THE SHOW GROUNDS.

COGGINS TEST: TEXAS STATE LAW REQUIRES THAT EACH HORSE BE ACCOMPANIED BY A
NEGATIVE EIA

CERTIFICATE DATED WITHIN ONE YEAR.

HEALTH CERTIFICATE: A HEALTH CERTIFICATE DATED WITHIN 21 DAYS OF ARRIVAL TO
BE PRESENTED WHEN ENTERING THE SHOW GROUNDS.

**YOUR HORSE HEALTH PAPERWORK MUST BE PRE-COPIED AND READY TO LEAVE AT
THE CHECK-IN OFFICE UPON ARRIVAL.**

ENTRY BLANKS MUST BE SIGNED BEFORE YOU CAN SCHOOL YOUR HORSE.



Double Oak Tack

Home of..

RENAISSANCE SADDLES
TUCCI BOOTS
STRUCK
CRINIERE LIFE
EPIQ
TROUVAILLE
OGILVY & more!

Thoughtfully curated
selection of over 100+
high end used saddles in
stock



www.doubleoaktack.com
info@doubleoaktack.com





BUILD YOUR OWN...

- ★ BURRITOS
- ★ TACOS
- ★ BOWLS
- ★ SALADS
- ★ NACHOS
- ★ QUESADILLAS

740 S MASON RD
KATY, TX 77450

SCAN HERE TO
ORDER ONLINE



NEW! BREAKFAST NEW!
7:00 AM - 10:35 AM

LUNCH AND DINNER
10:30 AM - 9:05 PM

STORE: (281) 396-4087

CATERING: (832) 476-2222

4 TOTAL LOCATIONS IN THE HOUSTON AREA



NEW! BREAKFAST TACOS
NEW! BREAKFAST BURRITOS

TACO BARS
NACHO BARS

BURRITO BOXED LUNCHES

CONTACT US FOR MORE INFO

(832) 476-2222

HOUSTONCATERING@CABOBODS.COM

OCTOBERFEST I & II

COMPETITION OFFICIALS

HORSE SHOW CONSIST OF TWO SEPARATE ONE-DAY SHOWS.
MANAGEMENT RESERVES THE RIGHT TO ADD TO OR VARY FROM THIS LIST.

COMPETITION MANAGEMENT



JUDGES

SARAH BOOKER (H)-COLUMBIA, MO

HAILEY ROGGE (H)- PINEHURST, TX

RUSSELL ERXLEBEN (J) – LIVINGSTON, TX

APPLICANT

GSEC

OPERATIONS MANAGER

AMY UNISS – KATY, TX

AUNISS@GSWEC.COM--281-978-0767

COURSE DESIGNER

HAILEY ROGGE – PINEHURST, TX

SHOW SECRETARY / SHOW OFFICE

WENDY HARRISON – KATY, TX

CAREN LUCKIE – HEMPSTEAD, TX

PADDOCK MASTERS/ANNOUNCERS

WENDY KAMINSKI – THE WOODLANDS, TX

TRACY SCHOEN-TOMBALL, TX

PARAMEDICS

H & H HEALTH AND SAFETY/EMS

CHRIS HOLCOMB (713) 204-0690

CHECK-IN GATE

GLENDIA GARD

AWARDS

ROSE HERNANDEZ

RECOGNIZED BY: GREATER HOUSTON HUNTER JUMPER ASSOCIATION

Trapp
O'Neal



Express your potential



 voltairedesign_official

 Voltaire Design

 @VoltaireDesign

VoltaireDesign.com

Quail Hollow Tack



PROVIDING THE FINEST QUALITY ENGLISH TACK
AND CLOTHING TO THE EQUESTRIAN COMMUNITY
FOR OVER 35 YEARS.

QuailHollowTack.com

6474 Cross Timbers • Flower Mound, TX • 75022

817-430-8250

GREAT SOUTHWEST EQUESTRIAN CENTER SPECIAL RATES AT Residence Inn by Marriott Houston Park Row



RESIDENCE INN BY MARRIOTT HOUSTON PARK ROW

1550 Barker Cypress, Texas 77084
(281) 829-2600
robin.moncrieffe@marriott.com

- 120 Suites with Full Sized Kitchens
- Conveniently located directly off of 1-10 at Barker Cypress
- From \$89 a Night Exclusively for the Great Southwest Equestrian Center

To Reserve a room call 281.829.2600 and ask for the Equestrian Center Rate

MEDICAL INFORMATION



NEAREST VETERINARY SURGICAL HOSPITAL

TEXAS A & M UNIVERSITY
86.5 MILES (1 HR 25 MIN)
500 RAYMOND STOTZER PKWY
COLLEGE STATION, TX 77843 (979) 845-3511

ON CALL VETERINARIAN

BRAZOS VALLEY EQUINE CLINIC (936) 825-2197

NEAREST EMERGENCY HOSPITAL – PARAMEDIC

MEMORIAL HERMANN TRAUMA CENTER
KATY HOSPITAL
6 MILES (15 MIN)
23900 KATY FREEWAY KATY, TX 77494 (281) 644-7000

HOUSTON METHODIST – WEST HOUSTON
18500 KATY FREEWAY
HOUSTON, TX 77094 (832) 552-1000

TEXAS CHILDREN’S HOSPITAL – WEST CAMPUS
18200 KATY FREEWAY HOUSTON, TX 77094
(832)227-1000

ON SITE PARAMEDIC

H & H HEALTH AND SAFETY
CHRIS HOLCOMB
(713) 204-0690



**WE PROVIDE CARE TO ALL EQUINE BREEDS AND DISCIPLINES,
FROM ROUTINE PREVENTATIVE MEDICINE TO ADVANCED
DIAGNOSTICS AND TREATMENT OF SPORT HORSES.**



Hospitalization and Ambulatory Services / Preventive Care / Prepurchase Examinations
Sports Medicine / Emergency Surgery / Elective Surgery / Digital Radiography / Digital Ultrasound
Endoscopy / Regenerative Medicine / Reproduction / Shockwave Therapy / Online Pharmacy

VISIT US AT OUR NEW FACILITY: 22121 GRATEHOUSE LANE, HEMPSTEAD, TX. 77445

www.decilloequine.com | Gustavo@decilloequine.com

FOR APPOINTMENTS OR EMERGENCIES: 979-826-2852

*We will find you and your
horse a great home!*



2001 Kirby Drive, Ste. 514 ♦ Houston, TX 77019 ♦ Phone: 713.526.4411
www.whelessproperties.com

GENERAL RULES AND INFORMATION

ENTRIES

ENTRY CLOSING DATE IS **THURSDAY, OCTOBER 12, 2023**. ENTRIES MUST BE COMPLETED AT WWW.HORSESHOWSONLINE.COM.

COMPLETELY FILLED OUT ENTRIES RECEIVED BY **WEDNESDAY** BEFORE THE SHOW AT 5 P.M. WILL GET A \$10 CREDIT ON ACCOUNT.

COMPETITION NUMBERS

OFFICE ISSUED NUMBERS MUST BE WORN IN THE COMPETITION RINGS.

SCHOOLING

ALL RINGS WILL BE OPEN FOR SCHOOLING ON FRIDAY FROM 12 P.M. UNTIL 6 P.M. ENTRY BLANKS MUST BE SIGNED BEFORE SCHOOLING. NO MANUAL POLING; NO OFFSETS OF ANY TYPE MAY BE USED WHILE SCHOOLING. JUMPING WILL BE PERMITTED SATURDAY AND SUNDAY UNTIL 30 MINUTES PRIOR TO SHOW TIME AND ONLY WHEN MEDICAL PERSONNEL ARE ON THE GROUNDS.

ATTIRE/HEADGEAR

ALL RIDERS MUST BE PROPERLY ATTIRED (SHIRTS WITH COLLARS AND EITHER BOOTS AND BREECHES OR PADDOCK BOOTS AND JODHPURS).

NUMBERS MUST BE WORN AND CLEARLY VISIBLE.

PROTECTIVE HEAD GEAR MUST BE WORN BY ALL RIDERS AT ALL TIMES WHILE MOUNTED, ANYWHERE, ANYTIME ON THE SHOW GROUNDS. HEADGEAR FOR ALL RIDERS MUST MEET OR EXCEED ASTM STANDARDS; MUST CARRY THE SEI TAG; AND BE PROPERLY SECURED BY A HARNESS. PROTECTIVE HEADGEAR IS REQUIRED FOR ALL RIDERS WHILE MOUNTED ON HORSES ON THE SHOW GROUNDS. JUNIOR EXHIBITORS MUST WEAR A HARNESS HAT APPROVED IN ACCORDANCE WITH 2023 USEF RULES. EFFECTIVE 12/1/2022 THE RULING ALSO APPLIES TO ADULTS WHETHER RIDING ON THE FLAT OR JUMPING AND WHEN JUMPING IS REQUIRED (INCLUDING SCHOOLING AND WARM-UP RINGS.) ANY RIDER VIOLATING THIS RULE AT ANY TIME WILL BE PROHIBITED FROM RIDING UNTIL HEAD GEAR IS PROPERLY IN PLACE.

OFFICE FEE/LATE FEE

A \$35 OFFICE FEE WILL BE CHARGED PER ENTRY PER SHOW DAY. ALL ENTRIES RECEIVED AFTER 6 PM, THURSDAY, THE WEEK OF THE SHOW WILL PAY A \$35 LATE FEE

STALL FEE/GROUNDS FEE/NON-SHOWING FEE

12X12 AND 10X10 PERMANENT STALLS (WITH DOORS) ARE AVAILABLE AT A COST OF \$110 PER WEEKEND. OVERNIGHT STALLS AT \$85 (ARRIVING AFTER 4 P.M. THE PREVIOUS DAY AND SHOWING ONE DAY ONLY). DAY STALLS AT \$55 (ARRIVING AND SHOWING SAME DAY). . SHIP-INS WILL BE CHARGED A \$55 GROUND/CLEAN UP FEE PER HORSE PER DAY. NON-SHOWING FEE WILL BE CHARGED AT \$50 PER DAY. HORSES SHOWING BOTH DAYS WILL BE CHARGED A WEEKEND STALL. NO OUTSIDE SHAVINGS ALLOWED, \$500 PER STALL FOR OUTSIDE SHAVINGS

MEMBERSHIP FEES

ALL RIDERS AND TRAINERS OF ENTRIES IN THIS SHOW MUST BE MEMBERS IN GOOD STANDING OF GHHJA OR PAY NON-MEMBER FEES. HORSES AND PONIES COMPETING FOR YEAR-END AWARDS MUST BE REGISTERED, AND THEIR OWNERS AND TRAINERS MUST BE MEMBERS.

MEMBERSHIP DUES ARE \$275 FOR LIFETIME MEMBERSHIP, \$45 ANNUAL FOR SENIORS (AGE 18 & OVER), \$40 ANNUAL FOR JUNIORS (UNDER AGE 18), OWNER/PARENT/OTHER ANNUAL \$35 AND HORSE/PONY REGISTRATION IS \$45 (LIFETIME) OR \$15 (ANNUAL). DUES MUST BE PAID TO SHOW SECRETARY OR PROOF OF MEMBERSHIP AND HORSE/PONY REGISTRATION MUST BE SUBMITTED BEFORE SHOWING. *DUPLICATE HORSE/PONY NAMES ARE NOT ALLOWED. A NON-MEMBER RIDER OR NON-MEMBER TRAINER MAY PARTICIPATE AFTER PAYING THE SHOW SECRETARY A "NON-MEMBER FEE" OF \$12.00 PER SHOW DAY. LEAD LINE PARTICIPANTS ARE EXEMPT FROM NON-MEMBER FEES. THE OWNER MUST FIRST CHECK THE CURRENT REGISTRATION LIST TO AVOID NAME DUPLICATION.

CREDIT CARD CONVENIENCE FEE

A CONVENIENCE FEE OF THREE (3) PERCENT OF THE TOTAL INVOICE WILL BE ADDED TO ALL INVOICES BEING PAID WITH A CREDIT CARD.



Care, Compassion, and Commitment

Your horses, our passion.

Whether you are in the arena, on a trail, or at home, Brazos Valley Equine Hospitals is committed to your success. We offer a comprehensive list of services provided by the best in the industry. With one of the few CT machines for horses installed, we can offer accurate imaging along with detailed diagnostics to help your horse reach its full athletic potential.



Navasota
(936)825-2197

Navasota Breeding
Division & Stallions
(936)727-7898

Cypress
(281)255-2280

Salado
(254)947-1292

Arizona
(281)255-2280

bveh.com

© JK DOWNLOAD ©



**YOUR TRUSTED LEADER
IN INSECT CONTROL**

GENERAL RULES AND INFORMATION



NON-NEGOTIABLE CHECKS

A \$50.00 SERVICE FEE OR 10% OF THE CHECK AMOUNT/CREDIT CARD CHARGE, WHICHEVER IS GREATER, WILL BE CHARGED FOR ALL RETURNED CHECKS AND/OR DECLINED CREDIT CARDS.

CAMPERS

CAMPER SPACES ARE AVAILABLE FOR \$55 PER DAY.

RINGS/FOOTING

MEGA RING 1 IS APPROXIMATELY 145' X 265' WITH ESI INTERNATIONAL ALL-WEATHER FOOTING. MEGA RING 2 IS APPROXIMATELY 145' X 265' WITH ESI INTERNATIONAL ALL-WEATHER FOOTING. ESI RING IS APPROXIMATELY 140' X 275' WITH ESI INTERNATIONAL ALL-WEATHER FOOTING. OTTO SPORT 2 IS APPROXIMATELY 125' X 275' WITH OTTO SPORT FOOTING. TELLEPSSEN INDOOR ARENA IS APPROXIMATELY 150' X 250' WITH SANDY LOAM FOOTING. MAIN INDOOR ARENA IS 150' X 300' WITH ESI INTERNATIONAL ALL-WEATHER FOOTING. WHELESS ARENA (EAST INDOOR) IS 125' X 250' WITH SANDY LOAM FOOTING. FOOTING IS A PRIORITY; RINGS MAY BE CLOSED TO SCHOOLING DURING INCLEMENT WEATHER AND/OR FOR MAINTENANCE AT ANY TIME DURING THE SHOW AT THE MANAGER'S DISCRETION.

COURSES

COURSES WILL BE POSTED A MINIMUM OF 30 MINUTES PRIOR TO EACH CLASS. IN HUNTER CLASSES, FENCES WILL SIMULATE FENCES FOUND IN THE HUNT FIELD SUCH AS; BRUSH, WALL, IN & OUT, OXER, POST AND RAILS, AND GATES. AT MANAGEMENT'S DISCRETION, A DOTTED LINE MAY BE PUT INTO EFFECT TO RESTRICT THE SIZE OF THE COURTESY CIRCLE IN HUNTER CLASSES.

RIBBONS/TROPHIES/CHAMPIONSHIPS

ALL HUNTER CLASSES RECEIVE A TROPHY AND EIGHT RIBBONS UNLESS OTHERWISE NOTED. ALL EQUITATION CLASSES RECEIVE A TROPHY AND EIGHT RIBBONS UNLESS OTHERWISE NOTED. ALL JUMPER CLASSES RECEIVE A TROPHY AND SIX RIBBONS UNLESS OTHERWISE NOTED. EACH HUNTER AND JUMPER SECTION WILL RECEIVE A CHAMPION & RESERVE AWARD BASED ON POINTS UNLESS OTHERWISE NOTED. SEE GHHJA RULE BOOK. IN ALL HUNTER SECTIONS, CHAMPION AND RESERVE CHAMPION WILL BE AWARDED TO TWO OF THE TOP FOUR HORSES ACQUIRING THE MOST POINTS OVER FENCES. THESE FOUR HORSES WILL ALSO RECEIVE FULL POINTS FOR ONE UNDER SADDLE CLASS.

PRIZE MONEY

ALL JUMPER AND HUNTER STAKE CLASSES ARE PAID 1ST – 3RD PLACE. 1ST = \$15 2ND = \$10 3RD = \$5

WARNING:

UNDER TEXAS LAW (CHAPTER 87, CIVIL, PRACTICE AND REMEDIES CODE), A FARM ANIMAL PROFESSIONAL OR FARM OWNER OR LESSEE IS NOT LIABLE FOR AN INJURY TO OR THE DEATH OF A PARTICIPANT IN FARM ANIMAL ACTIVITIES, INCLUDING AN EMPLOYEE OR INDEPENDENT CONTRACTOR, RESULTING FROM THE INHERENT RISKS OF FARM ANIMAL ACTIVITIES.

MANAGEMENT RESERVES THE RIGHT TO CHANGE, CANCEL, OR COMBINE CLASSES OR TO DO ANYTHING NECESSARY TO COMPENSATE FOR EXCESSIVE OR INADEQUATE ENTRIES. GREAT SOUTHWEST EQUESTRIAN CENTER L.P., AMY UNISS, MAURENE MOFFETT, PAULINE COOK OR GHHJA AND/OR THE SHOW MANAGEMENT OR EMPLOYEES IS NOT RESPONSIBLE FOR ANY LOSS, DAMAGE, OR INJURY TO ANY PERSONS, HORSES OR PROPERTY



Rudy's

REAL TEXAS BAR-B-Q[®]

SHIPPING NATIONWIDE

From Katy, TX



ORDER ONLINE AT **RUDYS.COM**

21799 KATY TOLLWAY || 832-772-7242

...AND DON'T FORGET TO STOP BY FOR BREAKFAST, LUNCH & DINNER

CLASS SPECIFICATIONS

***DENOTES GHHJA RECOGNIZED CLASS**

***WALK-TROT DIVISION ENTRY FEE: \$40/PER CLASS**

NO CROSS ENTRIES. FOR RIDERS WHO HAVE NOT WON 6 BLUE RIBBONS AT ANY SHOW. RIDERS ELIGIBLE AT THE BEGINNING OF THE SHOW YEAR REMAIN ELIGIBLE ALL YEAR.

1. WALK-TROT EQUITATION
2. WALK-TROT HORSEMANSHIP
3. WALK-TROT INDIVIDUAL TEST FIG. 8
4. WALK-TROT POLES

*** PRE-BEGINNER ENTRY FEE: \$40/PER CLASS**

FOR RIDERS WHO HAVE NOT JUMPED OVER 18" AND HAVE NOT WON 6 CUMULATIVE BLUE RIBBONS O/F AT ANY SHOW (WARM-UP NOT TO COUNT). RIDERS ELIGIBLE AT THE BEGINNING OF THE SHOW YEAR REMAIN ELIGIBLE ALL YEAR. FENCES 18". TROT OR CANTER.

5. PRE-BEGINNER EQUITATION W/T/C
6. PRE-BEGINNER EQUITATION O/F
7. PRE-BEGINNER EQUITATION O/F
8. PRE-BEGINNER EQUITATION O/F

*** BEGINNER ENTRY FEE: \$40/PER CLASS**

FOR RIDERS WHO HAVE NOT JUMPED OVER 2' AND HAVE NOT WON 6 CUMULATIVE BLUE RIBBONS O/F AT ANY SHOW PRIOR TO 2012. RIDERS ELIGIBLE ALL YEAR. (PRE-BEG & WARM-UP NOT TO COUNT). FENCES 2' MAXIMUM.

9. BEGINNER EQUITATION FLAT
10. BEGINNER EQUITATION O/F
11. BEGINNER EQUITATION O/F
12. BEGINNER EQUITATION O/F

*** GREEN AS GRASS ENTRY FEE: \$40/PER CLASS**

STAKE CLASS ENTRY FEE: \$35 FENCES 2'3". FOR HORSES OR PONIES WHO HAVE NOT SHOWN OVER FENCE PRIOR TO THE START OF CURRENT SHOW YEAR. NO CROSS ENTRIES INTO CLASSES OVER 2'3".

13. GREEN AS GRASS HUNTER U/S
14. GREEN AS GRASS HUNTER
15. GREEN AS GRASS HUNTER
16. GREEN AS GRASS HUNTER STAKE

*** NOVICE ENTRY FEE: \$40/PER CLASS**

FOR RIDERS WHO HAVE NOT WON 6 CUMULATIVE BLUE RIBBONS OVER FENCES AT ANY GHHJA/THJA/USEF (AFFILIATED) RECOGNIZED SHOW IN A RECOGNIZED DIVISION AND WHO HAVE NOT SHOWN OVER 3'. (WARM-UP, PRE-BEG AND BEGINNER RIBBONS DO NOT COUNT.) RIDERS ELIGIBLE ALL YEAR. FENCES 2'3"

17. NOVICE EQUITATION FLAT
18. NOVICE EQUITATION O/F
19. NOVICE EQUITATION O/F
20. NOVICE EQUITATION O/F

GSEC HUNTER ENTRY FEE: \$40/PER CLASS

FENCES 2'6". OPEN TO ALL.

21. GSEC HUNTER U/S
22. GSEC HUNTER
23. GSEC HUNTER
24. GSEC HUNTER

***PONY HUNTER ENTRY FEE: \$40/PER CLASS**

STAKE CLASS ENTRY FEE: \$35 OPEN TO PONIES A JUNIOR EXHIBITOR AGE 14 & UNDER AS OF START OF SHOW YEAR.

- NO IN & OUTS. FENCES 2', 2'3, 2'6 TO 2'9
25. PONY HUNTER UNDER SADDLE
 26. PONY HUNTER
 27. PONY HUNTER
 28. PONY HUNTER STAKE

*** LIMIT HUNTER ENTRY FEE: \$40/PER CLASS**

FOR RIDERS WHO HAVE NOT WON SIX (6) CUMULATIVE BLUE RIBBONS OVER FENCES AT ANY GHHJA/THJA/USEF (AFFILIATED) RECOGNIZED SHOW. BEGINNER, NOVICE, OR SCHOOLING HUNTER RIBBONS DO NOT COUNT AGAINST THIS DIVISION. BLUE RIBBONS WON IN THE PONY DIVISION AT THJA/USEF DO COUNT TOWARD ELIGIBILITY; HOWEVER, BLUES WON IN THE PONY DIVISION AT GHHJA DO NOT COUNT TOWARDS LIMIT ELIGIBILITY. RIDERS ELIGIBLE AT THE BEGINNING OF THE SHOW YEAR REMAIN ELIGIBLE ALL YEAR. FENCES 2'6".

33. LIMIT HUNTER UNDER SADDLE
34. LIMIT HUNTER
35. LIMIT HUNTER
36. LIMIT HUNTER STAKE

*** LONG STIRRUP / SHORT STIRRUP FEE: \$40/PER CLASS**

FENCES 2'0". OPEN TO JUNIOR/ADULT AMATEUR RIDERS ON HORSES OR PONIES. NO CROSS ENTRIES FOR HORSE/RIDER COMBINATION INTO ANY OTHER DIVISION AND NO RIDER TO CROSS IN TO ANY DIVISION OVER 2'3". NO OXERS OR IN & OUTS. MANNERS SHALL BE EMPHASIZED AND EXTREME SPEED PENALIZED. 3 RIDERS NEEDED IN EACH SECTION TO SPLIT THE DIVISION LONG STIRRUP OPEN TO SR. AMATEUR (ADULT) RIDERS (OVER THE AGE OF 18) AT BEGINNING OF THE YEAR & SHORT STIRRUP OPEN TO JUNIOR RIDERS AT THE BEGINNING OF THE YEAR (AGE 17 & UNDER)

94. LONG STIRRUP / SHORT STIRRUP EQ ON FLAT
95. LONG STIRRUP / SHORT STIRRUP EQ O/F
96. LONG STIRRUP / SHORT STIRRUP HUNTER O/F
97. LONG STIRRUP / SHORT STIRRUP HUNTER O/F

*** PRE-GREEN HUNTER ENTRY FEE: \$40/PER CLASS STAKE CLASS ENTRY FEE: \$45**

FENCES 2'6" – 2'9". FOR HORSES AND PONIES WHO HAVE NOT SHOWN PRIOR TO CURRENT SHOW YEAR OVER FENCES EXCEEDING 2'3" IN ANY SHOW. NO CROSS ENTRIES INTO CLASSES OVER 3'3".

37. PRE-GREEN HUNTER U/S
38. PRE-GREEN HUNTER
39. PRE-GREEN HUNTER
40. PRE-GREEN HUNTER STAKE

***JUNIOR/ADULT HUNTER ENTRY FEE: \$40/PER CLASS STAKE CLASS ENTRY FEE: \$45**

FENCES 2'9"-3'. OPEN TO ALL AMATEUR RIDERS. PONIES MAY SHOW IN JUNIOR /ADULT HUNTER CLASSES BUT MAY NOT SHOW IN ANY OTHER PONY DIVISION AT THE SAME SHOW.

41. JUNIOR/ADULT U/S
42. JUNIOR/ADULT HUNTER
43. JUNIOR/ADULT HUNTER
44. JUNIOR/ADULT HUNTER STAKE

***LOW HUNTER ENTRY FEE: \$40/PER CLASS STAKE CLASS ENTRY FEE: \$45**

FENCES 2'9" – 3'. OPEN TO ALL HORSES, PONIES AND RIDERS.

45. LOW HUNTERS U/S
46. LOW HUNTERS
47. LOW HUNTERS
48. LOW HUNTERS STAKE

*** NON-PRO HUNTER ENTRY FEE: \$40/PER CLASS STAKE CLASS ENTRY FEE: \$45**

FENCES 2'6" – 2'9". OPEN TO NON-PRO RIDERS.

49. NON-PRO HUNTER U/S
50. NON-PRO HUNTER
51. NON-PRO HUNTER
52. NON-PRO HUNTER STAKE

Looking for a young horse?

Look no further

Check out

www.oldeoaksfarm.com

WE HAVE YOUNGSTERS BY:

SHINE

RAGTIME

DIAMO BLUE

BLISS MF



Vicki@oldeoaksfarm.com

713-806-7108

**Our youngsters are handled regularly and are
microchipped and USEF/USHJA lifetime registered.**

2 Sallie B Wheeler Central winners



AVALON

TRUST. TALENT. VISION

www.avalonadvisors.com

CLASS SPECIFICATIONS

*DENOTES GHHJA RECOGNIZED CLASS

* SCHOOLING HUNTER

ENTRY FEE: \$40/PER CLASS
STAKE CLASS ENTRY FEE: \$45

FENCES 2'3". OPEN TO ALL.
57.SCHOOLING HUNTER U/S
58.SCHOOLING HUNTER
59.SCHOOLING HUNTER
60.SCHOOLING HUNTER STAKE

*OPEN HUNTER

ENTRY FEE: \$40/PER CLASS
STAKE CLASS ENTRY FEE: \$45

FENCES 3'3". OPEN TO ALL HORSES AND RIDERS.
101.OPEN HUNTER U/S
102.OPEN HUNTER
103.OPEN HUNTER
104.OPEN HUNTER STAKE

*SCHOOLING JUMPER

ENTRY FEE: \$45/PER CLASS

FENCES 2'9" – 3'. MAX SPREADS 3'. OPEN TO ALL. TIME ALLOWED WILL BE POSTED AND ANNOUNCED.
61.SCHOOLING JUMPER. TIME FIRST JUMP-OFF
62.SCHOOLING JUMPER. TIME FIRST ROUND
63.SCHOOLING JUMPER. POWER & SPEED

* JUNIOR/ADULT JUMPER

ENTRY FEE: \$45/PER CLASS

FENCES 3' – 3'3". OPEN TO JR/ADULT AM. RIDERS. JUMP-OFF MAXIMUM 3'6" WITH 3'6" SPREADS. TIME ALLOWED WILL BE POSTED AND ANNOUNCED.
57.JR./ADULT JUMPER. TIME FIRST JUMP-OFF
58.JR./ADULT JUMPER. TIME FIRST ROUND
59.JR./ADULT JUMPER. POWER & SPEED

GSEC JUMPER

ENTRY FEE: \$45/PER CLASS

FENCES 3' – 3'3". OPEN TO ALL RIDERS. JUMP-OFF MAXIMUM 3'6" WITH 3'6" SPREADS. TIME ALLOWED WILL BE POSTED AND ANNOUNCED.
29.GSEC JUMPER. TIME FIRST JUMP-OFF
30.GSEC JUMPER. TIME FIRST ROUND
31.GSEC JUMPER. POWER & SPEED

* OPEN JUMPER

ENTRY FEE: \$45/PER CLASS

OPEN TO ALL. FENCES 3'6" FIRST ROUND. JUMP-OFF MAX 4'3", MAX SPREAD 4'. TIME ALLOWED WILL BE POSTED AND ANNOUNCED.
60.OPEN JUMPER. TIME FIRST JUMP-OFF
61.OPEN JUMPER. TIME FIRST ROUND
62.OPEN JUMPER. POWER & SPEED

* ITTY BITTY JUMPER

ENTRY FEE: \$45/PER CLASS

OPEN TO HORSES OR PONIES NOT SHOWING IN OTHER JUMPER DIVISIONS OR ANY HUNTER OR EQUITATION CLASSES W/FENCES OVER 2'6". FENCES NO HIGHER THAN 2'6".
63.ITY BITTY JUMPER. TIME FIRST JUMP-OFF
64.ITY BITTY JUMPER. TIME FIRST ROUND
65.ITY BITTY JUMPER. POWER & SPEED

* MISCELLANEOUS CLASSES

ENTRY FEE

66.LEAD LINE \$0
67.WARM-UP \$40
68.WARM-UP \$40
69.WARM-UP (PRE-BEGINNER) ... \$40
70.WARM-UP (BEGINNER)... \$40
71.WARM-UP – (LONG / SHORT STIRRUP ONLY) \$40
72.WARM-UP – (PONY ONLY) \$40

* MISCELLANEOUS CLASSES

ENTRY FEE

*80. JUNIOR/ADULT EQUITATION-FLAT\$40
*81. JUNIOR/ADULT EQUITATION O/F-FENCES3'- 3'3".....\$40
*82. LIMIT EQUITATION-FLAT \$40
*83. LIMIT EQUITATION. FENCES 2'6" \$40
*84. PONY EQUITATION –FLAT \$40
*85. PONY EQUITATION O/F \$40

FENCES: 2' FOR SMALL PONIES, 2'3" FOR MEDIUM PONIES, 2'6" – 2'9" FOR LARGE.

*86. PONY MEDAL

ENTRY FEE: \$40

OPEN TO GHHJA MEMBER & NON-MEMBER PONY RIDERS. NOT TO BE DIVIDED BY SIZE. FENCES 2' FOR SMALL, 2'3" FOR MEDIUM, 2'6" TO 2'9" FOR LARGE. THREE RIDERS MUST COMPLETE THE COURSE FOR POINTS TO COUNT AT YEAR END. TWO OR MORE USEF TEST 1-9 OF THE TOP FOUR RIDERS WILL BE REQUIRED.

*87. LIMIT MEDAL.

ENTRY FEE: \$40

OPEN TO GHHJA MEMBER AND NON-MEMBER LIMIT RIDERS. FENCES 2'6" MAX. THREE RIDERS MUST COMPLETE THE COURSE FOR POINTS TO COUNT AT YEAR END. TWO OR MORE USEF TESTS 1-9 OF TOP FOUR RIDES WILL BE REQUIRED

*98. GHHJA MEDAL

ENTRY FEE: \$40

JUNIOR/ADULT. OPEN TO JUNIOR OR ADULT AM GHHJA MEMBERS AND NON-MEMBERS. 2 OR MORE USEF TESTS 1- 19 WILL BE REQUIRED OF THE TOP 4 RIDERS. THREE RIDERS MUST COMPLETE THE COURSE. FENCES 3'

**THREE RIDERS MUST BE ENTERED BEFORE START
OF MEDAL CLASS FOR CLASS TO BE HELD**



Memorial Park Hunters

Congratulations to our THJA year end Champions and Reserve Champions!



Elisabeth Marek & Last Man
Reserve Champion
15-17 Equitation



Emmy Canterbury & Bada Bing Bada Blue
Champion Small/Medium
Children's Pony Hunter



MJ Maestas & Major Sassafras
Reserve Champion
Short Stirrup



Laura Carter & Divides Freedom Spirit – Champion Large Children's Pony Hunter

Our clients are successful in the Hunter, Jumper, Pony and Equitation rings.

We have a place for the beginner rider, the competitive rider and everyone in between!

Top Ponies and Horses For Sale

Patty Roberts (713) 683-8636 • (713) 805-8266 • Houston, Texas

Conveniently located inside the 610 Loop

memorialparkhunters.com



Horse & Rider Portraits | Senior Portraits | Family Portraits

capturing
the magic you feel inside
with your once in a lifetime horse

Now Booking Portrait Sessions at Your Farm through the Spring of 2024

equine@karindak.com | equine.karindak.com

OCTOBERFEST I & II

SATURDAY & SUNDAY

OCTOBER 14 & 15

MAIN ARENA 8:30 AM

- 70 ITTY BITTY JUMPER (TFJO)
- 71 ITTY BITTY JUMPER (TFR)
- 72 ITTY BITTY JUMPER (P&S)

- 61 SCHOOLING JUMPER (TFJO)
- 62 SCHOOLING JUMPER (TFR)
- 63 SCHOOLING JUMPER (P&S)

- 29 GSEC JUMPER (TFJO)
- 30 GSEC JUMPER (TFR)
- 31 GSEC JUMPER (P&S)

- 64 JR/ADULT JUMPER (TFJO)
- 65 JR/ADULT JUMPER (TFR)
- 66 JR/ADULT JUMPERR (P&S)

- 67 OPEN JUMPER (TFJO)
- 68 OPEN JUMPER (TFR)
- 69 OPEN JUMPER (P&S)

D BARN 7:30 AM

- 73 LEADLINE
- 1 WALK TROT EQUITATION
- 2 WALK TROT HORSEMANSHIP
- 3 WALK TROT INDIVIDUAL TEST
- 4 WALK TROT POLES

- 5 PRE-BEGINNER EQ W/T/C
- 76 PRE-BEGINNER WARM UP
- 6 PRE-BEGINNER EQ O/F
- 7 PRE-BEGINNER EQ O/F
- 8 PRE-BEGINNER EQ O/F

- 77 BEGINNER WARM UP
- 10 BEGINNER EQ O/F
- 11 BEGINNER EQ O/F
- 12 BEGINNER EQ O/F
- 9 BEGINNER EQ FLAT

- 99 WALK ONLY

ESI 8:00AM

- 75 WARM UP 2'3"
- 58 SCHOOLING HUNTER O/F
- 59 SCHOOLING HUNTER O/F
- 60 SCHOOLING HUNTER STAKE
- 57 SCHOOLING HUNTER U/S

- 14 GREEN AS GRASS HUNTER O/F
- 15 GREEN AS GRASS HUNTER O/F
- 16 GREEN AS GRASS HUNTER STAKE
- 13 GREEN AS GRASS HUNTER U/S

- 18 NOVICE EQUITATION O/F
- 19 NOVICE EQUITATION O/F
- 20 NOVICE EQUITATION O/F
- 17 NOVICE EQUITATION FLAT

- 78 WARM UP 2'
- 95 SHORT/ LONG STIRRUP EQ O/F
- 96 SHORT/ LONG STIRRUP HTR O/F
- 97 SHORT/ LONG STIRRUP HTR O/F
- 94 SHORT/ LONG STIRRUP EQ FLAT

- 79 WARM UP
- 85 PONY EQUITATION
- 86 PONY MEDAL
- 26 PONY HUNTER O/F
- 27 PONY HUNTER O/F
- 28 PONY HUNTER STAKE
- 25 PONY HUNTER U/S
- 84 PONY EQUITATION FLAT

- 105 GSEC 2' HUNTER O/F
- 106 GSEC 2' HUNTER O/F
- 107 GSEC 2' HUNTER O/F
- 108 GSEC 2 HUNTER U/S

MEGA 9:00AM

- 74 WARM UP
- 46 LOW HUNTER O/F
- 47 LOW HUNTER O/F
- 48 LOW HUNTER STAKE
- 45 LOW HUNTER U/S

- 81 JR/ ADULT EQUITATION O/F
- 42 JR/ ADULT HUNTER O/F
- 43 JR/ ADULT HUNTER O/F
- 44 JR/ ADULT HUNTER STAKE
- 41 JR/ ADULT EQUITATION U/S
- 80 JR/ ADULT EQUITATION FLAT
- 98 GHJJA MEDAL

- 102 OPEN HUNTER O/F
- 103 OPEN HUNTER O/F
- 104 OPEN HUNTER STAKE
- 101 OPEN HUNTER U/S

- 38 PRE-GREEN HUNTER O/F
- 39 PRE-GREEN HUNTER O/F
- 40 PRE-GREEN HUNTER STAKE
- 37 PRE-GREEN HUNTER U/S

- 50 NON PRO HUNTER O/F
- 51 NON PRO HUNTER O/F
- 52 NON PRO HUNTER STAKE
- 49 NON PRO HUNTER U/S

- 83 LIMIT EQUITATION O/F
- 34 LIMIT HUNTER O/F
- 35 LIMIT HUNTER O/F
- 36 LIMIT HUNTER STAKE
- 82 LIMIT EQUITATION FLAT
- 33 LIMIT HUNTER U/S
- 87 LIMIT MEDAL

- 22 GSEC HUNTER O/F
- 23 GSEC HUNTER O/F
- 24 GSEC HUNTER O/F
- 21 GSEC HUNTER U/S



We Proudly Support Great Southwest Equestrian Center

Michael U. Ellington, Jr.
SVP/Senior Managing Director
Bernstein Private Wealth Management
800 Capitol Street, Suite 3550
Houston, TX 77002

The [A/B] logo is a registered service mark of AllianceBernstein and AllianceBernstein® is a registered service mark used by permission of the owner, AllianceBernstein L.P.
© 2022 AllianceBernstein L.P.

Jerry Mohme Photography

Specializing in Equine Photography
Available for events and portrait sessions.



(512) 203-2809
www.jerrymohmephoto.com
jerrymohmephoto@gmail.com

*Immortalize your
champion!*

Olva Stewart Pharo

- portraits in pencil or bronze
- commissions
- unique trophies

www.olvastewartpharo.com
portraits@texhorseman.com
281-373-9304



*"SPIRIT on the Hunt",
portrait bronze,
10" x 17"*



Breaux Ranch

344± Acres | \$6,480,000 | Grimes County, Anderson, TX



Hickory Wind Farm

608± Acres | \$17,000,000
Henderson & Van Zandt Counties, Edom, TX



3P Ranch

114± Acres | \$3,000,000 | Milam County, Buckholts, TX



Pioneer Equestrian Facility

40± Acres | \$4,500,000 | Montgomery County, Conroe, TX

info@republicranches.com | 888-726-2481 | www.republicranches.com

SADDLE UP & STAY WITH YOUR 2 HOUSTON "NEIGH"BORS



WE ARE THE OFFICIAL
PARTNER HOTELS OF GSWEC



HOUSTON
I-10 WEST/PARK ROW

ROOM RATES STARTING AT \$79/NIGHT



COURTYARD[®]
BY MARRIOTT

HOUSTON
I-10 WEST/PARK ROW

ROOM RATES STARTING AT \$89/NIGHT

HOTEL AMENITIES

- In-Room Mini Fridge & Microwave
- Complimentary Breakfast
- Complimentary WiFi
- Complimentary & Ample Parking
- Pet Friendly
- Outdoor Pool
- Fitness Center

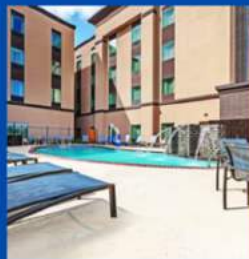

HOTEL AMENITIES

- In-Room Mini Fridge & Microwave
- In-House Bistro
- Complimentary WiFi
- Complimentary & Ample Parking
- Pet Friendly
- Outdoor Pool
- Fitness Center



FOR RESERVATIONS, PLEASE CONTACT HOTEL DIRECTLY

HAMPTON INN & SUITES
281.578.6700

18014 PARK ROW DR, HOUSTON, TX 77084
HOUSTON110WESTPARKROW.HAMPTONBYHILTON.COM

COURTYARD
281.492.7979

18010 PARK ROW DR, HOUSTON, TX 77084
MARRIOTT/HOUPS



FLEXIBLE, TAILORED COVERAGE FOR EQUINE OPERATIONS

Whether you keep a pony for weekend recreation or raise elite breeding stallions, it makes good business sense to choose an insurance agent who understands your specific coverage needs.

PROPERTY COVERAGE:

Home | Barns | Hay and Grain | Machinery | Farm Supplies | Tack

LIABILITY COVERAGE:

Care, Custody and Control | Clinics | Riding Instruction | Boarding Shows | Hay and Sleigh Rides



SHANNON GALVIN

Agent

PO Box 420
Cypress, TX 77410

SMART THINKING. REWARDED®

✉ s.galvin@american-national.com

☎ 713.857.5554



<http://an.insure/shannongalvin>

Products and services may not be available in all states. Terms, conditions and eligibility requirements will apply. Property and casualty products and services may be underwritten in Texas by American National Property and Casualty Company, American National County Mutual Insurance Company or American National Lloyd's Insurance Company, each of Springfield, Missouri.

AN-146 8/26/12 12:16



KRISTIE SCHOLTEN

fine art portrait photography

832-971-8886

www.kristiescholten.com

formerly Moonfyre Photography

RENT NEW, FULLY STOCKED RV'S



**DELIVERED & SET UP
AT THE SHOW**

346-289-0601

TxRvAdventures.com

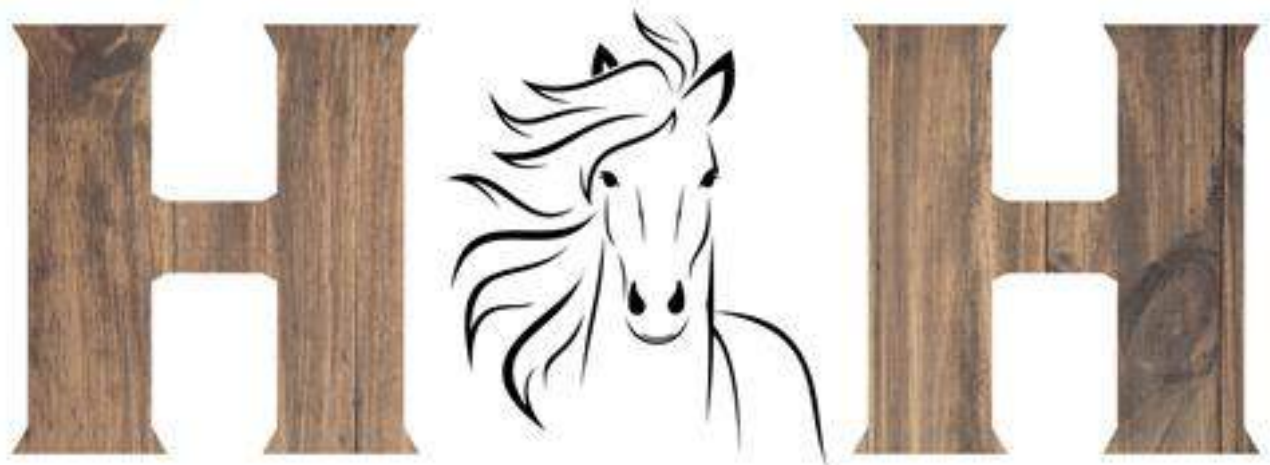

Event First Aid Services

hh.health.safety@gmail.com

713-204-0690



Riding *is an Art*

Carrasca Z

Antarès Custom Saddles
210 N. 21st Street, Suite C
Purcellville, VA 20132
800-250-9284
www.antares-sellier.com



Antarès workshop
Antarès Sellier France
34, rue des Fougères
17100 Saintes
France